

ELITE

manual

1.

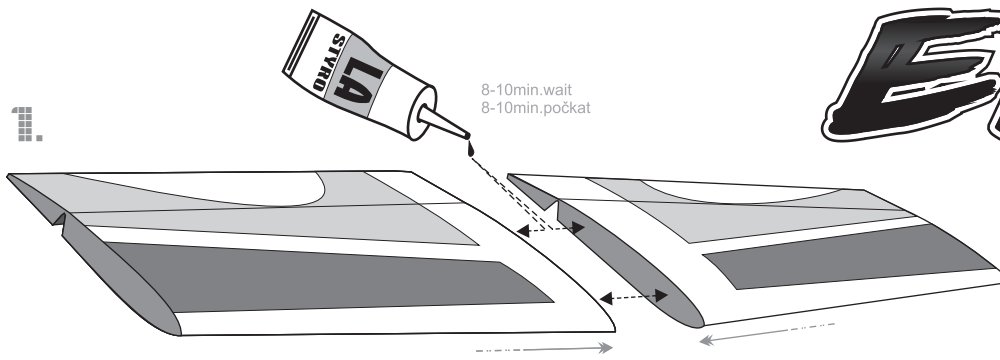

2.

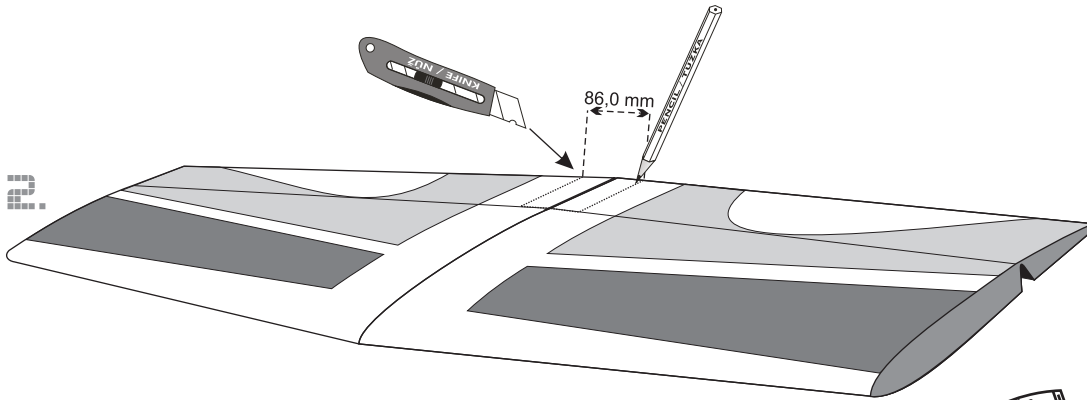

3.

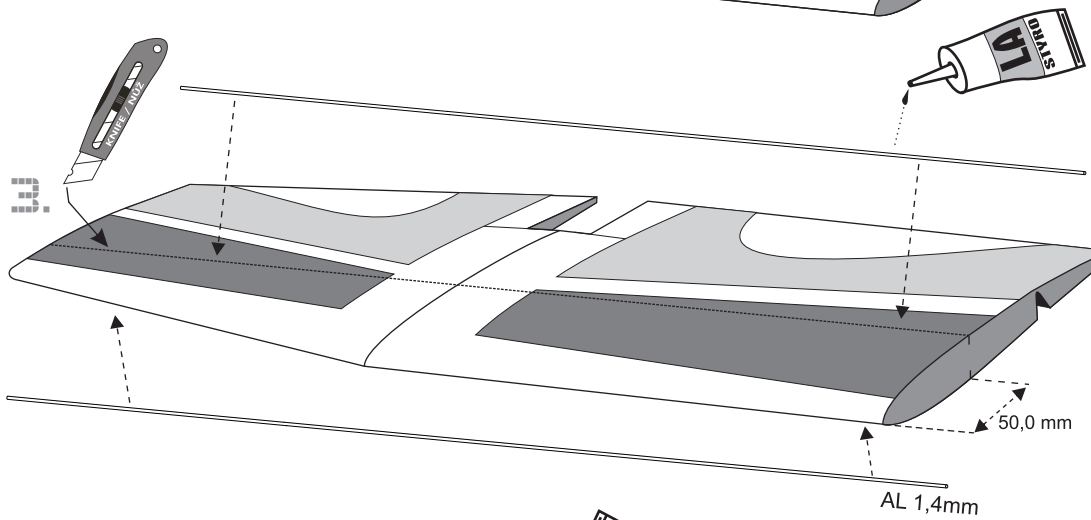

4.

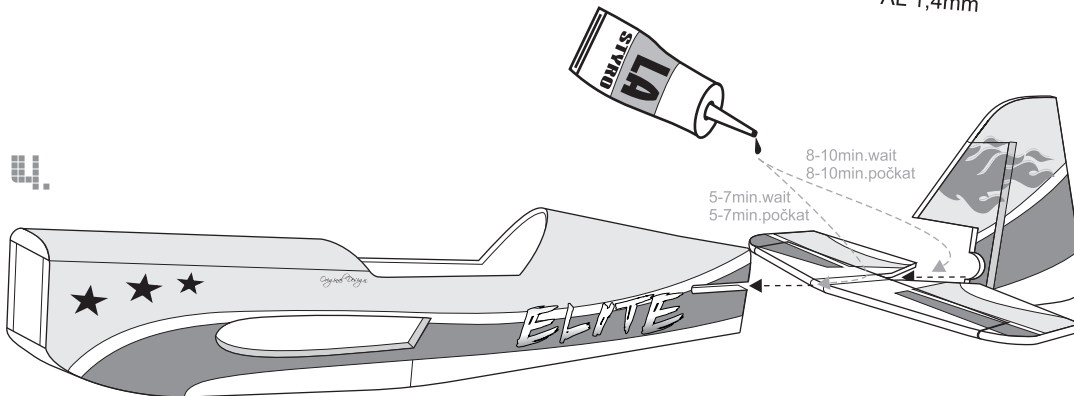

5.

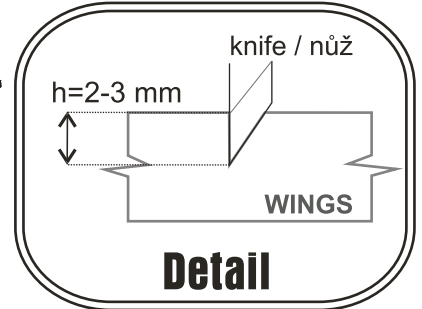
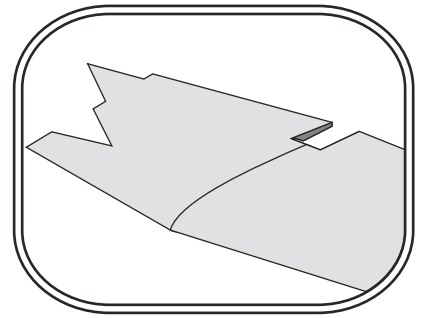
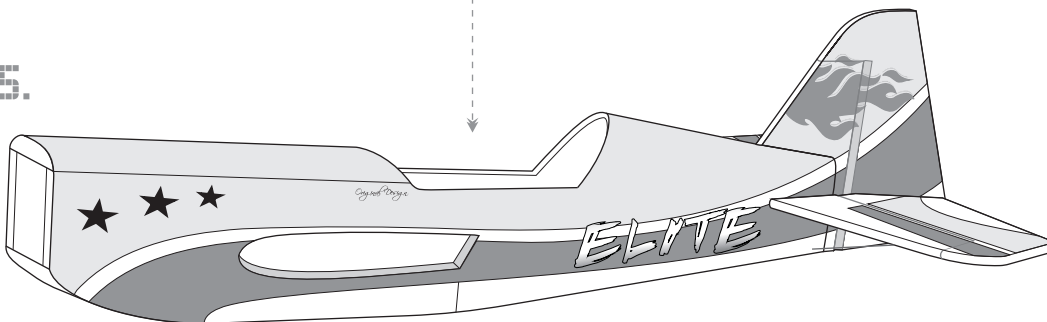

- Do křídel vyřežeme ostrým nožem drážku pro přiložené AL dráty do horní i spodní plochy, poté tyto AL dráty vsuneme do drážek a následně je zalepíme (použijte LA tmel nebo lepidlo pro Styro).
- Cut into the wings a slit for the reinforcing AL wires (the knife must be as sharp as possible) in the top and bottom surface of the wings, then insert and glue up these wires into the wings (by LA tmel or glue for Styro).

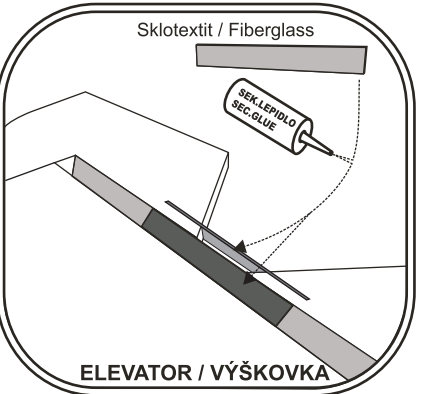

- Obě pohyblivé části výškovky spojíme zalepením sklotextit. obdelníků, výškovku vsuneme do výřezu, zkontrolujeme rovinu a zalepíme.
- Both moving parts of the elevator put together by fiberglass rectangle. This elevator insert into the fuselage cutout, check that the empennage is parallel to the respective planes and glue up.

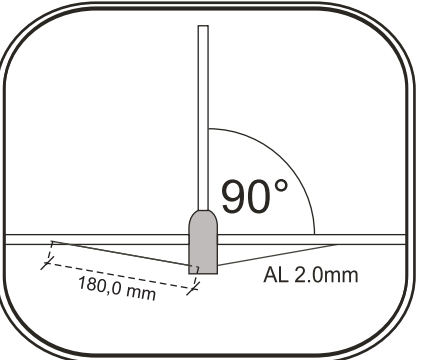

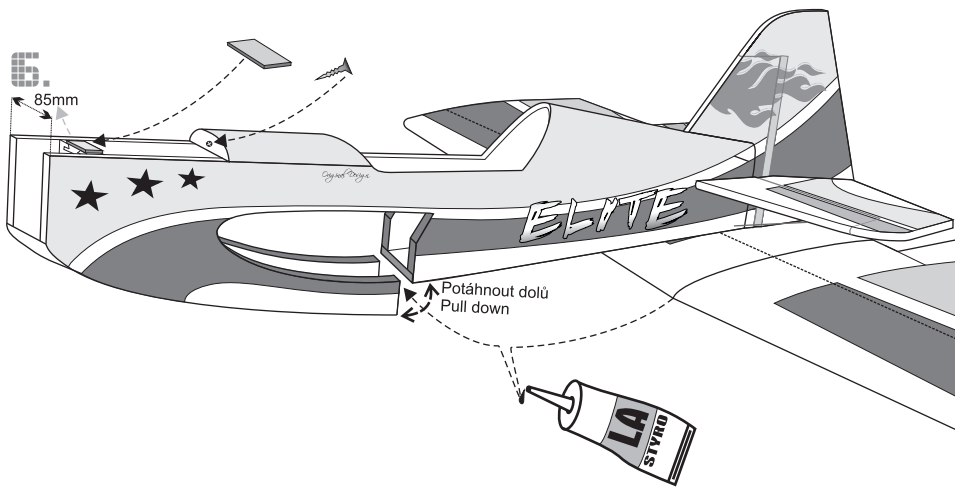

Otevřete výřez v trupu a poté do něj vsuňte a zalepte křídla modelu (LA tmel, Styro). Podvozek zalepte do druhého výřezu v trupu lepidlem PUREX!

Open the cutout of the fuselage. Then insert and glue up Katana wings into the fuselage cutout. The landing gear glue up into the second fuselage cutout by PUREX glue!

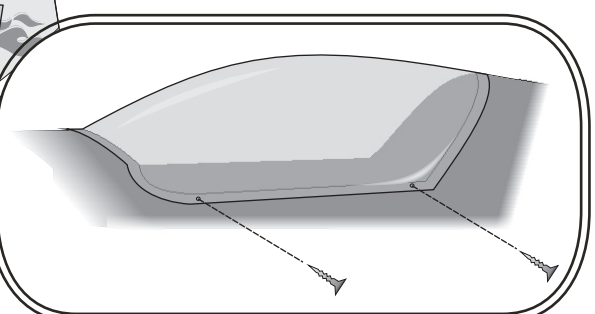
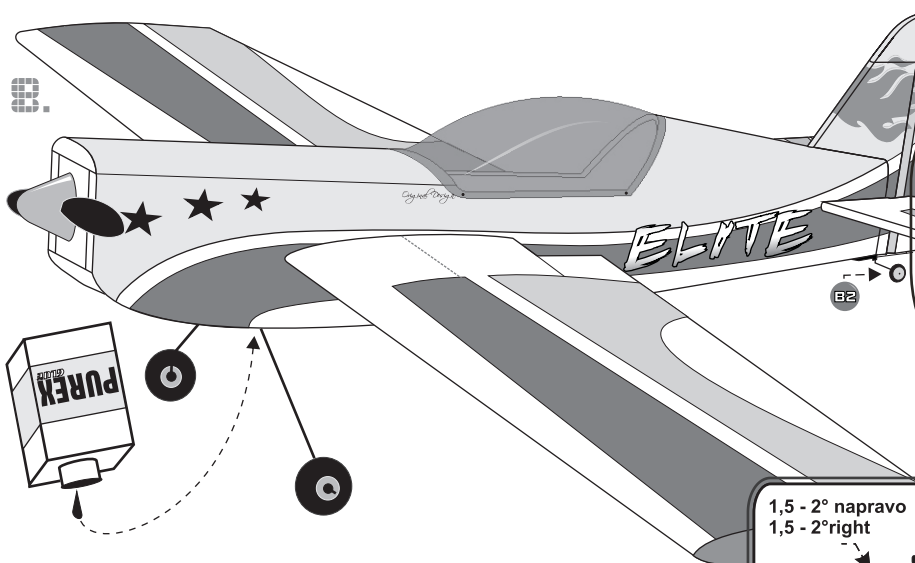
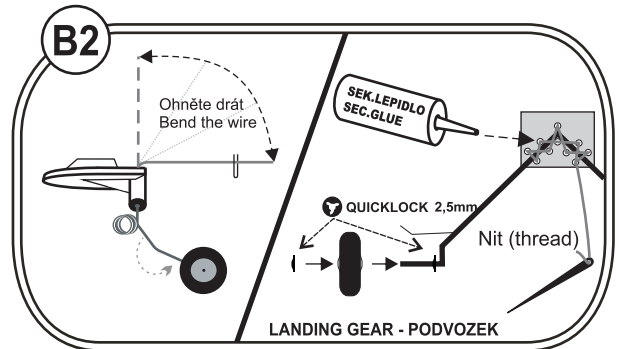
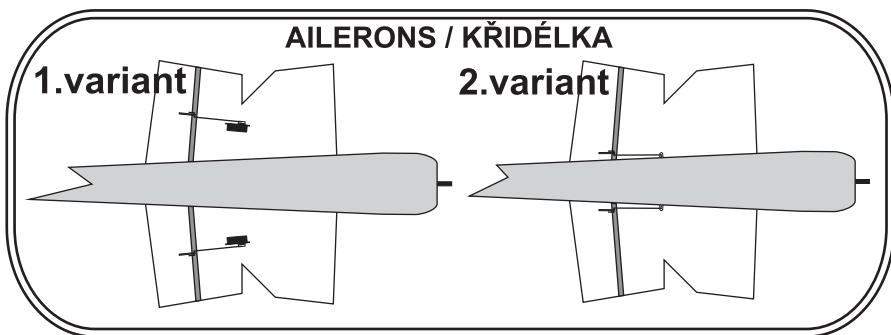
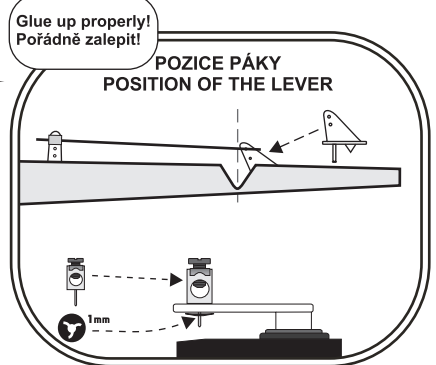
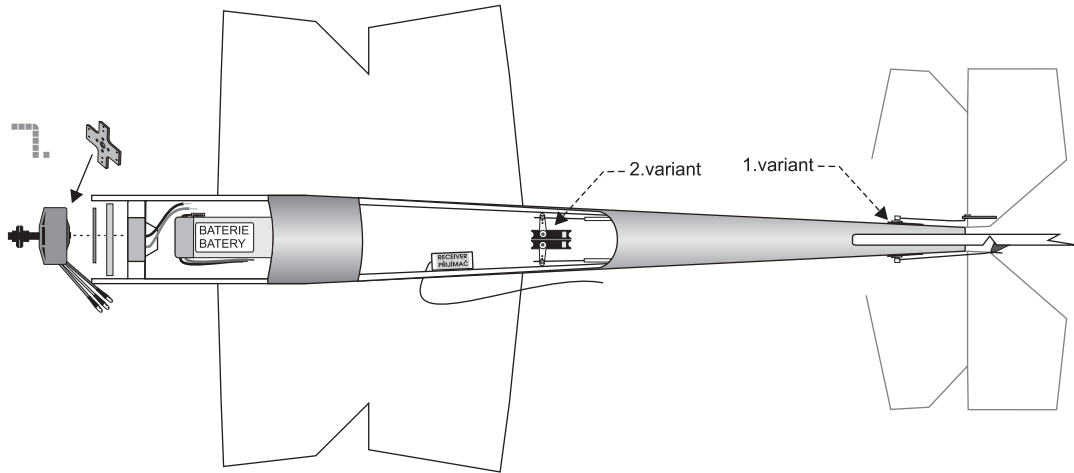
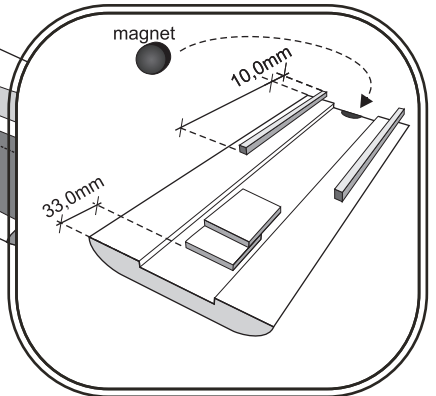

- Těžiště modelu je 90-100 mm od náběžné hrany křídla (pro začínající piloty), pokročilí mohou těžiště posouvat až k hodnotě 100-115mm. Výchyly doporučujeme nastavit dle vlastních letových zkušeností, nejméně však +/- 15%.
- Center of gravity position is 90-100mm on the wing (for beginners), 100-115 mm possible for advanced pilots. We recommend to adjust the deflection of the control surface-ailerons and empennage according to one's own habits and experience, however they should be at least +/- 15 degrees.

